

LINKA

WIFI HD AUDIO IN CAR

USER GUIDE

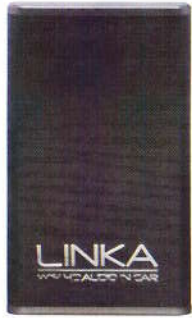

nexum-design.com

Quick Installation



- ① Make sure 3.5mm Audio Jack insert AUX port of car audio system
- ② Let USB male connect to any of female USB port to get the power for LINKA.

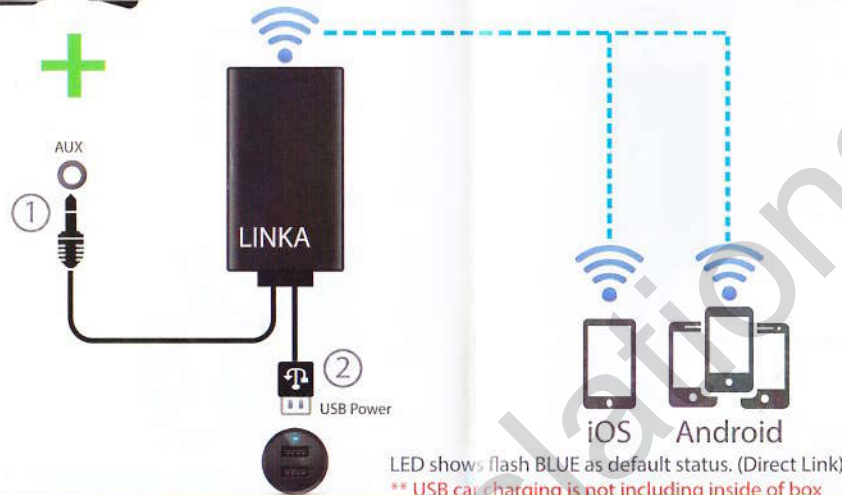

Product Information



UPOCC audio cable which can provide HIFI level audio quality. Cable line about 30-35 cm

iPhone/iPad Devices (AirPlay for iOS)

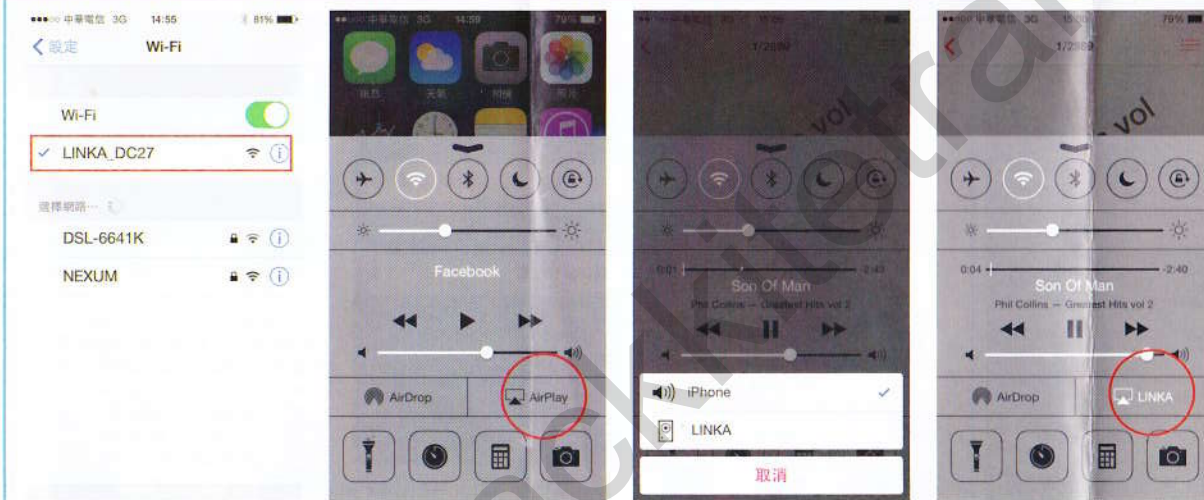

Entry WiFi Setup page then connect to [LINKA_XXXX] directly. AirPlay will ready to go.
 (The existing 3G connection of iPhone will keeps working when WiFi connected to LINKA.)
 NOTE: iOS need to upgrade to iOS6 at least.

Change Device Name

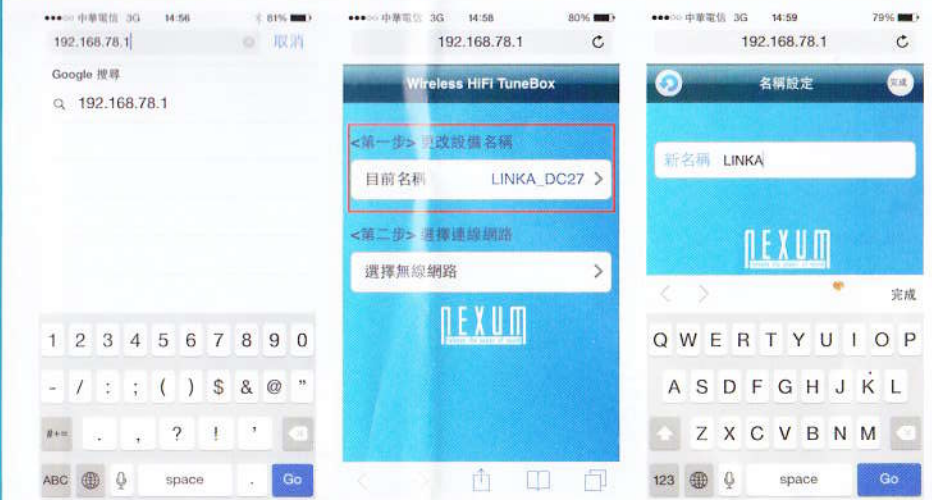

[Change Device Name]
 If you want to change the device name, please open Safari app then type "192.168.78.1" on address bar to entry setup page of LINKA.
 (Please ignore step 2 when you're using Direct Link Mode)

Android Devices (DLNA for Android 4.0 above)

Recommend 3rd party app of Google Play (Support DLNA)

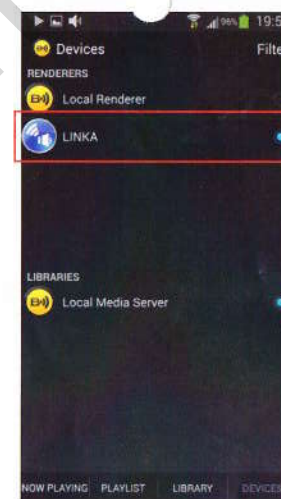
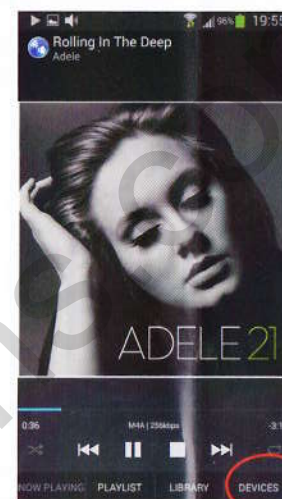

LINKA support native music player of HTC/SONY/ Samsung android device. (example - HTC M8)



Note -

① 3G will disconnected when WIFI connect to LINKA directly. ② Android device only able to play the music which stored inside of devices.

NET LINK

LINKA is able to connect to HOME WiFi Network as well. Only need to entry setup page for network selection.



[Back to Default Status]

Press RESET 3~5 secs then LED will turns blue flashing status.

Specification

Support OS	<ul style="list-style-type: none"> iOS 5.0 or above iTunes 10.1 or above Android 4.0 or above Windows XP/Vista/7/8
Audio Format	MP3, WAV, WMA, AAC, M4A, AIFF, ALAC, FLAC
WiFi Spec	802.11 b/g/n
Cover Range	70 meters (Direct Play Mode)
Output I/F	AUX
SNR	89dB
Dimension	85 x 50 x 15mm
Power Domain	DC 5V /500mA

FCC statement and declaration: Molu Technology declares that this device complies with Part 15 of the FCC rules and regulations. Operation of this device is to the following two conditions:

- 1) This device may not cause harmful interference
- 2) This device must accept any interference received, including interference that may cause undesire operation.



Design by NEXUM | Assembled in Taiwan